

# Research Proposal

Agnieszka Opadczuk

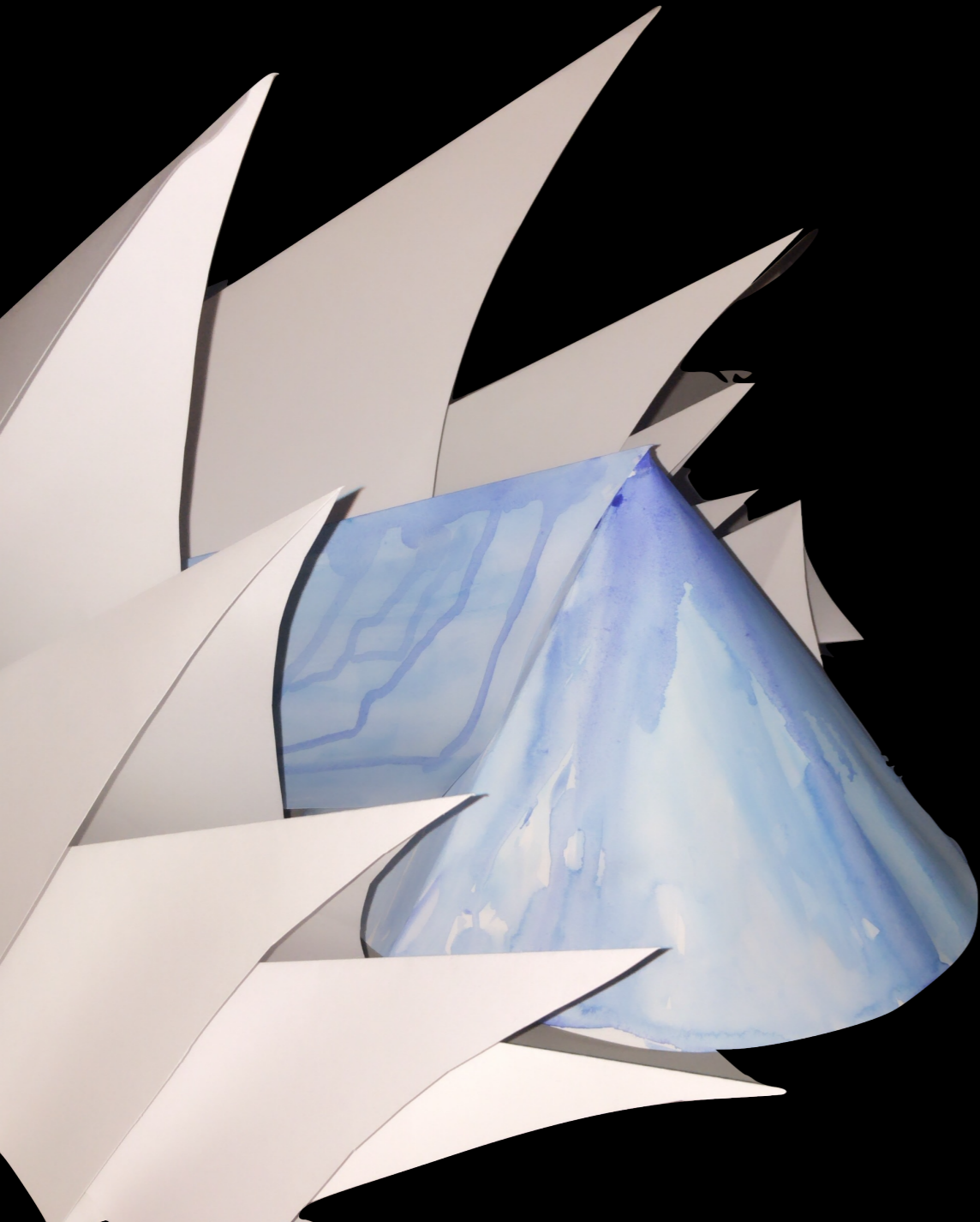

# Research Direction

How does the architecture of the museum building influence the exhibits inside. (Form, light and space.) Should the museum building be considered an art work itself? Can it define our outlook on the pieces of art or is it just a supplement and people should look at the building and art as a whole.

# Inspiration Board

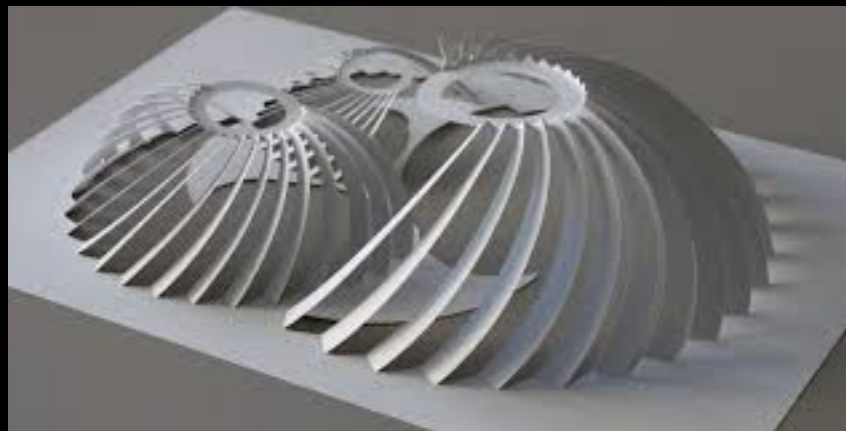
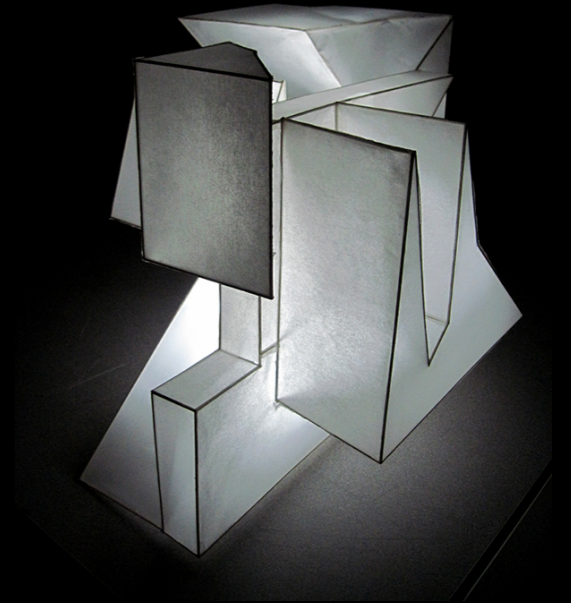



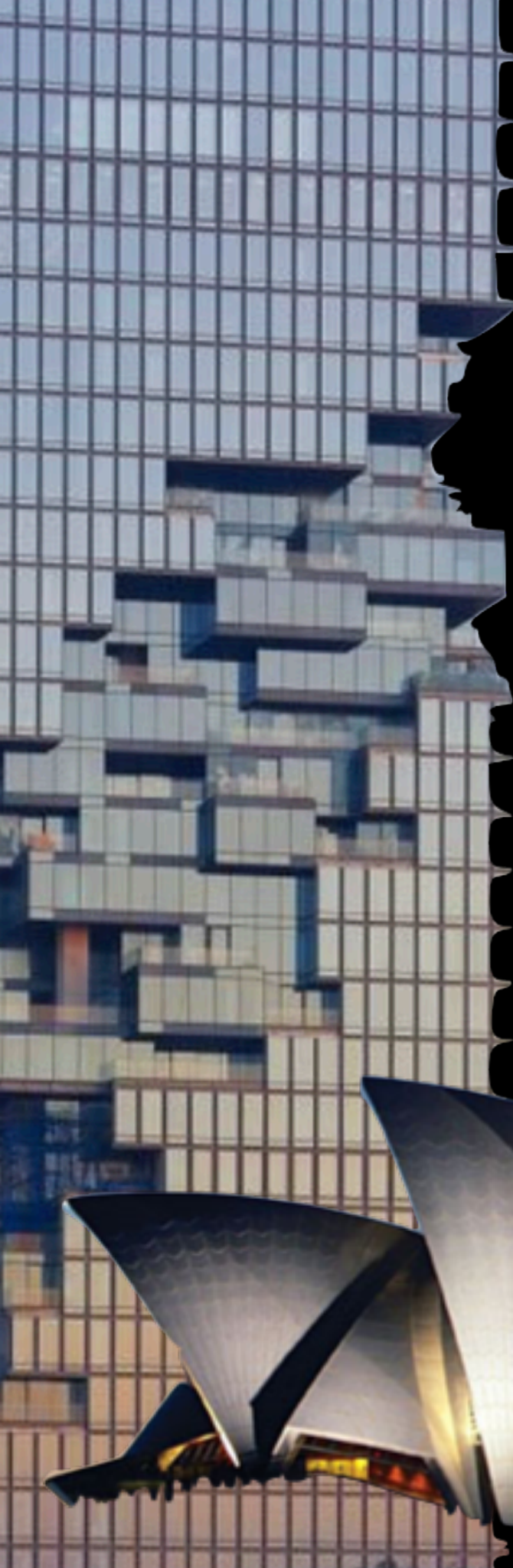

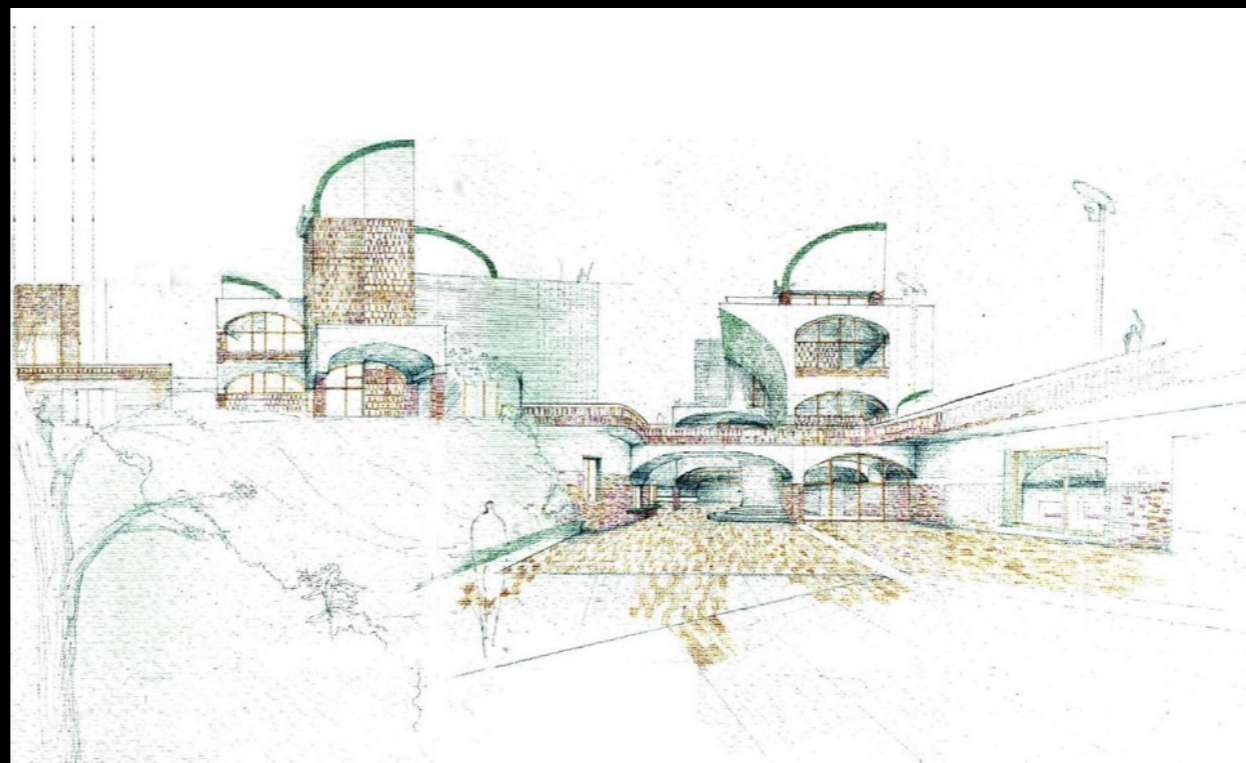



©Agencja Gazeta

# Sketches

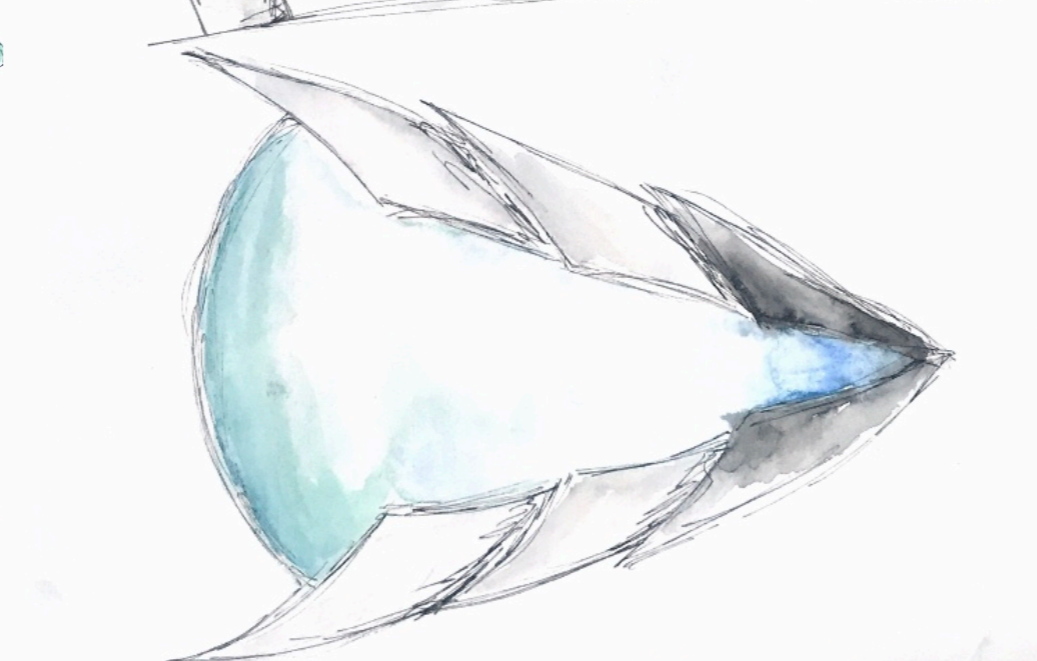
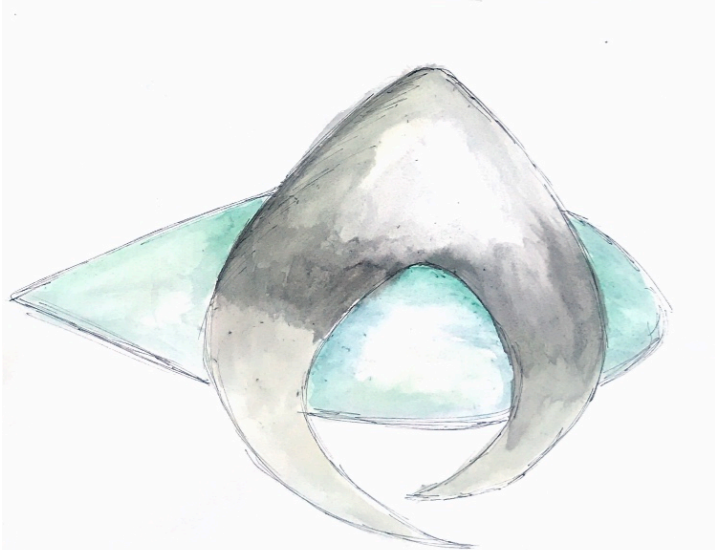
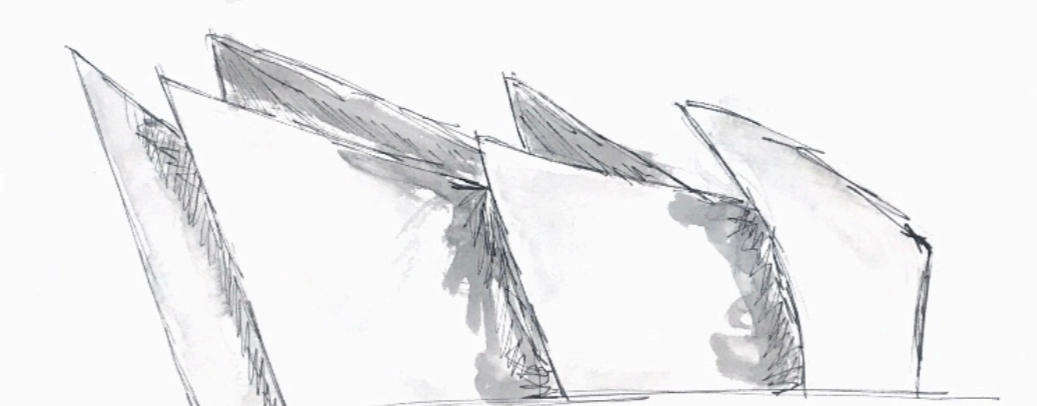
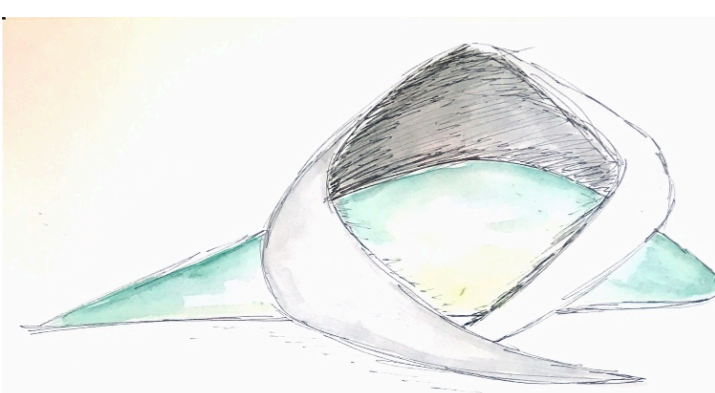
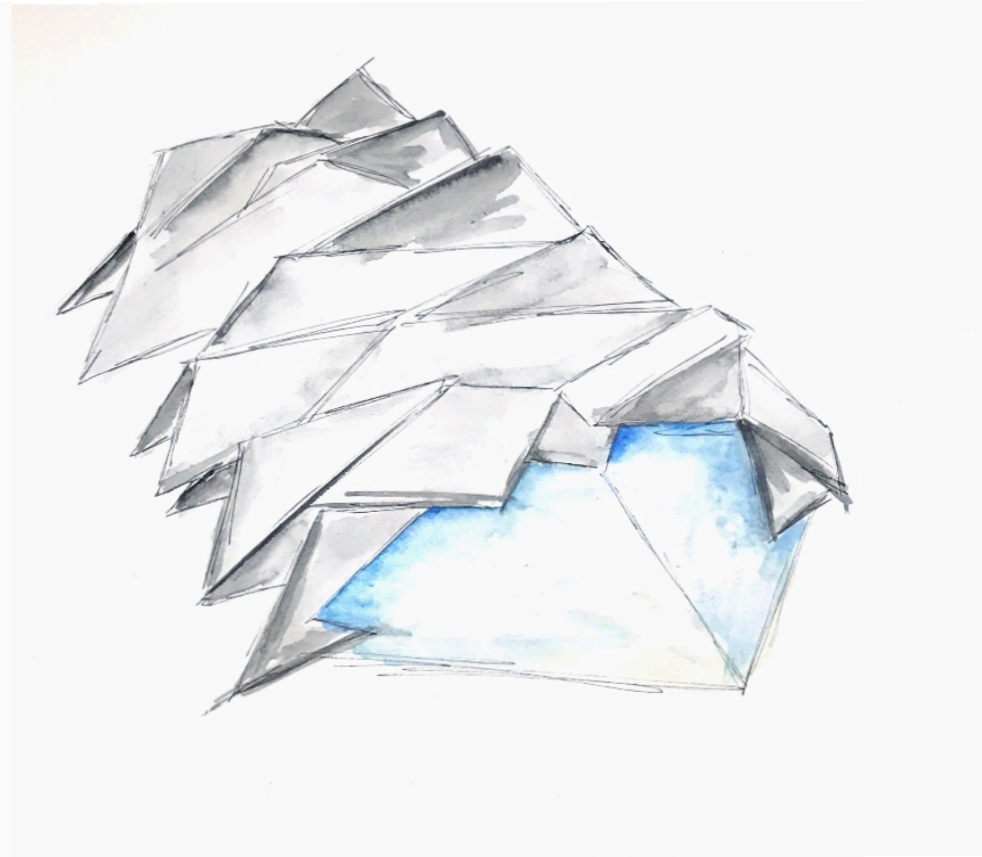
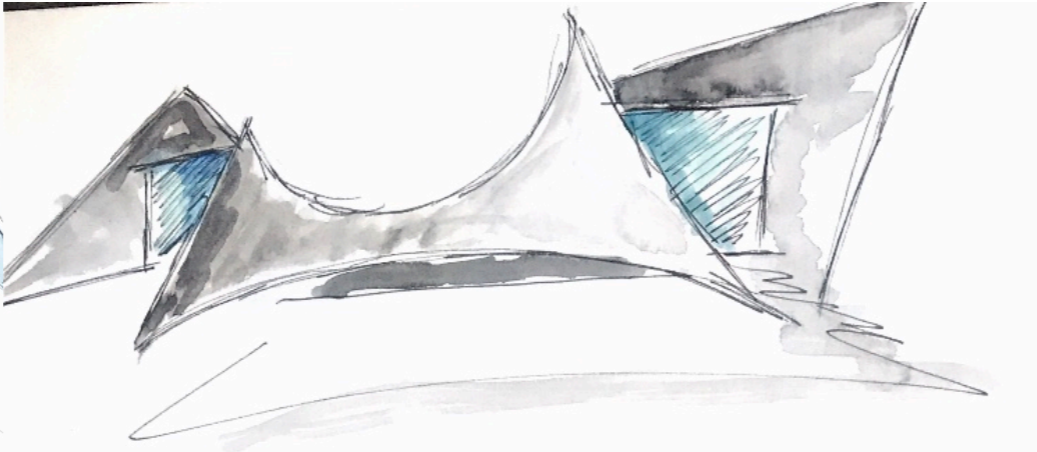
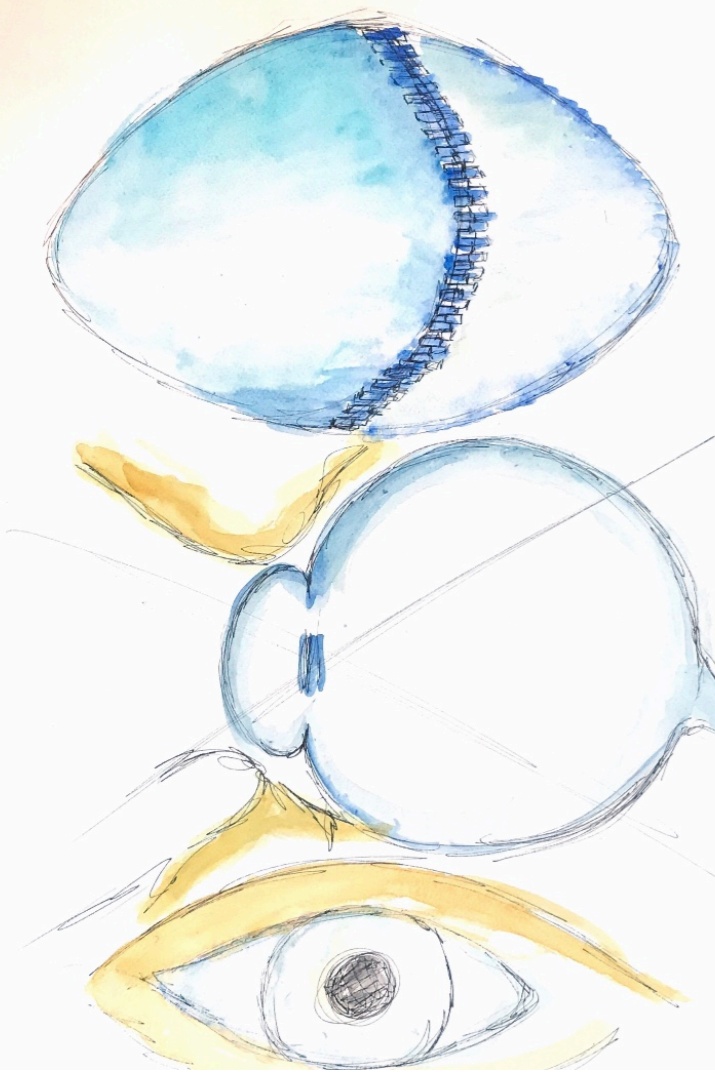



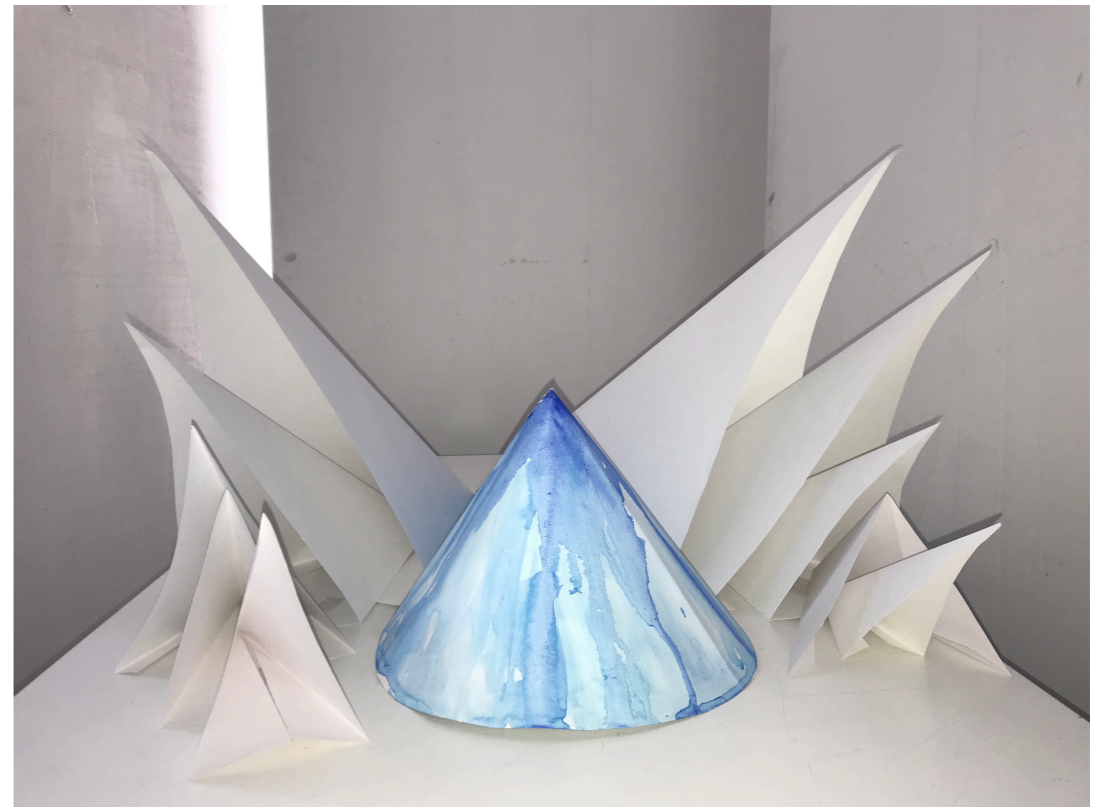
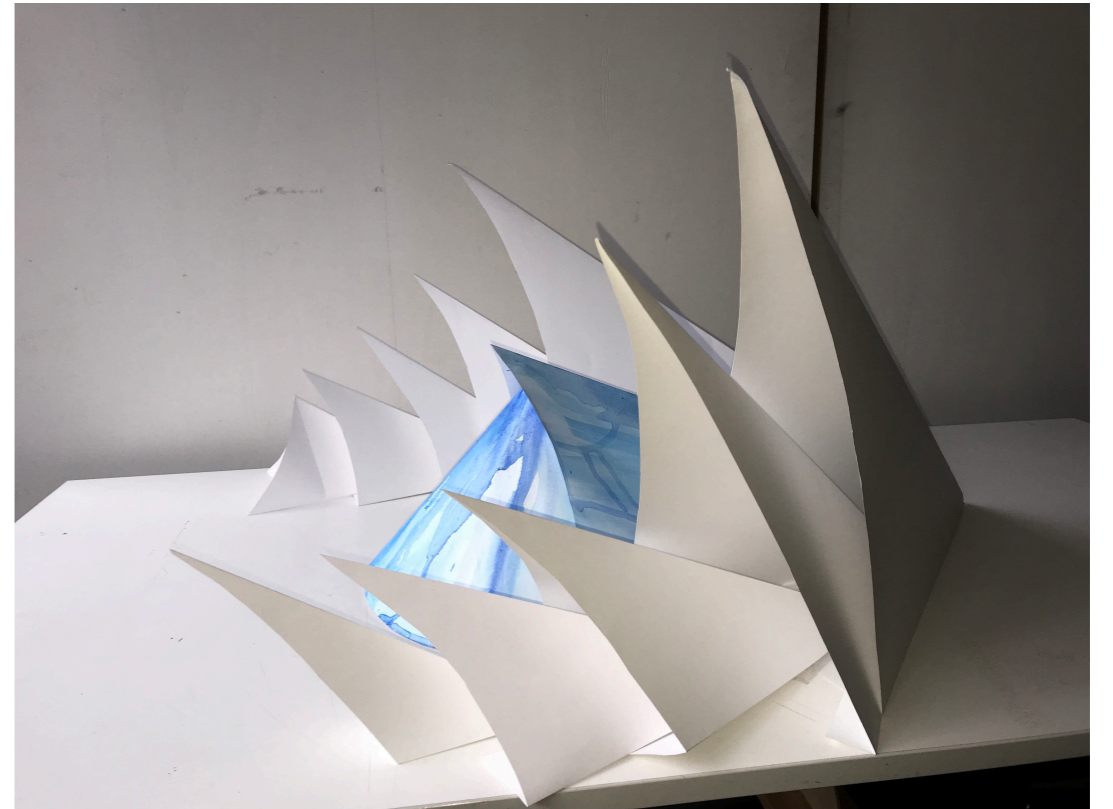
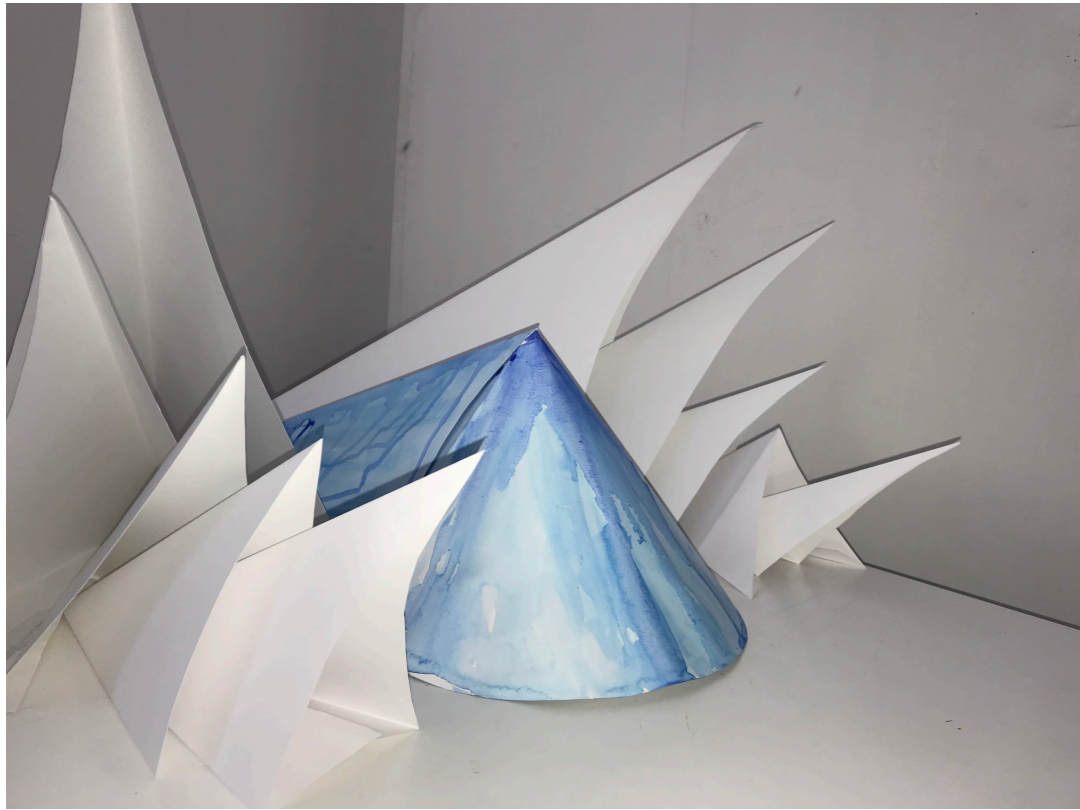

# Prototype

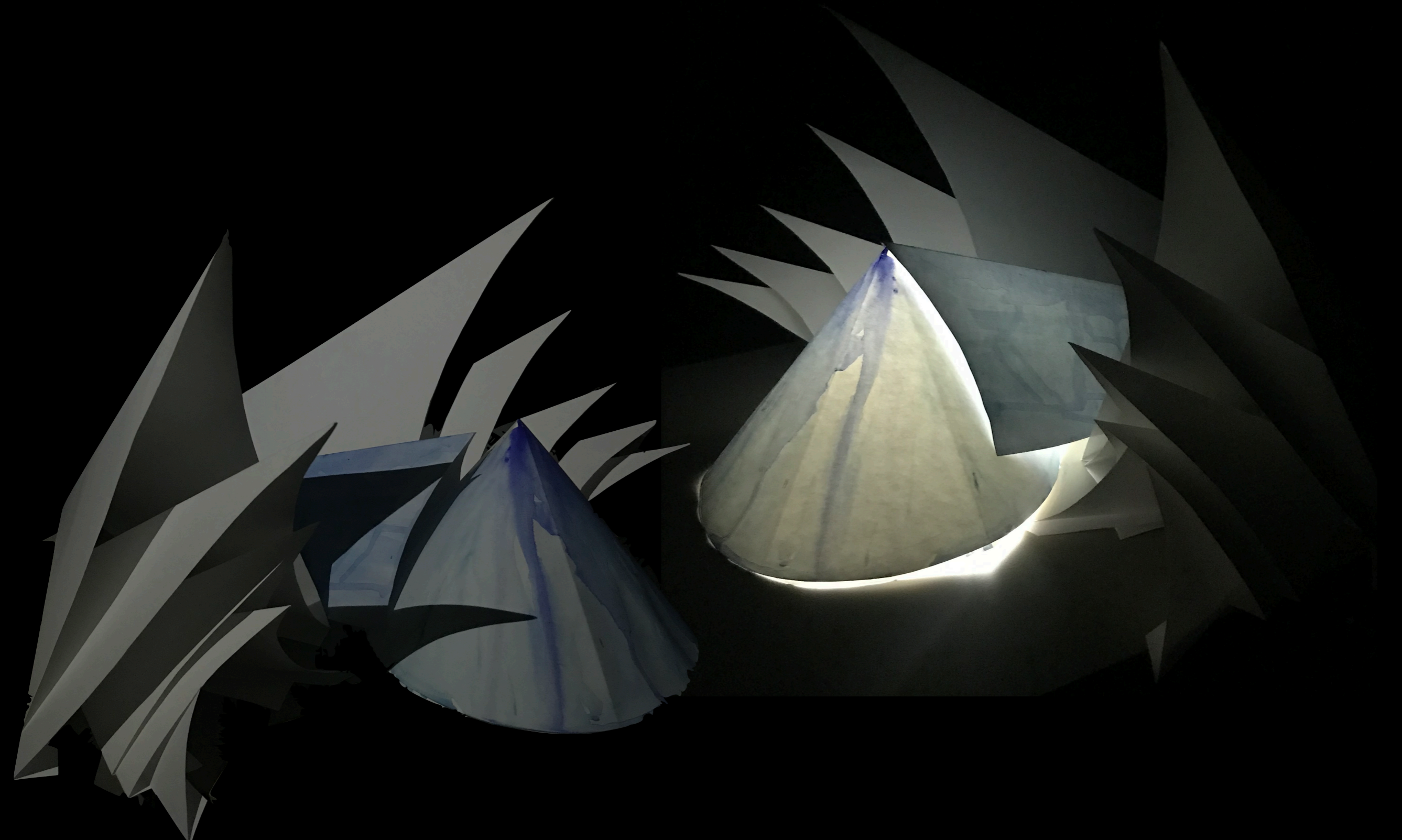

# Link Between Seminar

The knowledge I will gain from the research conducted for my seminar paper I will be glad to implement to my studio assignment which will be a prototype/ mockup model of the museum building. I will try to apply what worked well in presented buildings and avoid their failure to achieve the most convenient museum space.