



Red Hippo Dances

Deniz Kefeli

The first step of this project was visiting a site and measuring the rooms that were assigned to each one of us. After this step, we created section and elevation drawings by hand and digitally. We created a 3D model and 2D perspectives of this model. And added texture to these drawings.

The project was focused on the motion. First we taped our selected rooms on to the floor in 1:1 scale. Secondly, we recorded motion in the taped areas. By gathering all of these recordings on illustrator, 9 images of motion were created. The graphic lines diagram these actions.

Deniz Kefeli

- 
- P.01 Drawing**
 - P.02 Motion Analysis**
 - P.03 Imagining New Occupations**



The first step of this project was visiting a site and measuring the rooms that were assigned to each one of us. After this step, we created section and elevation drawings by hand and digitally. We created a 3D model and 2D perspectives of this model. And added texture to these drawings.

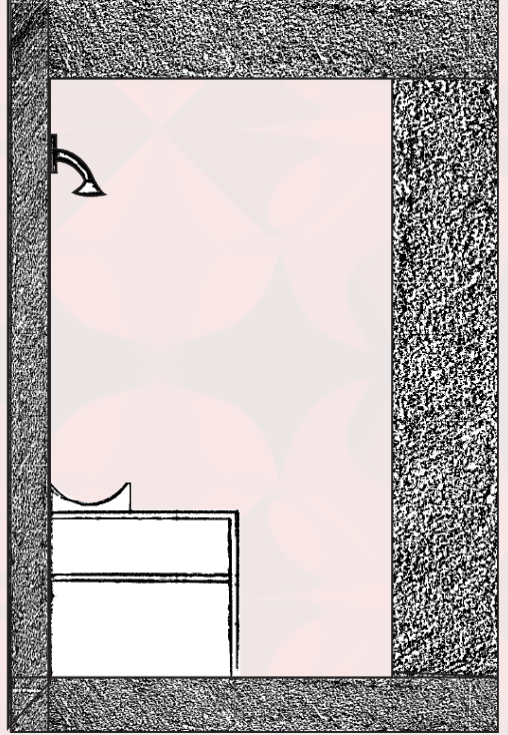
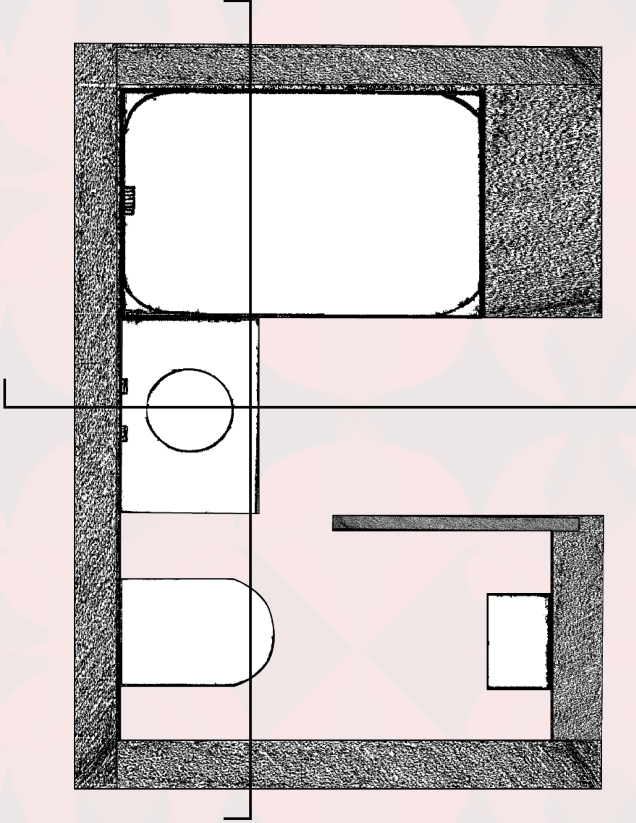

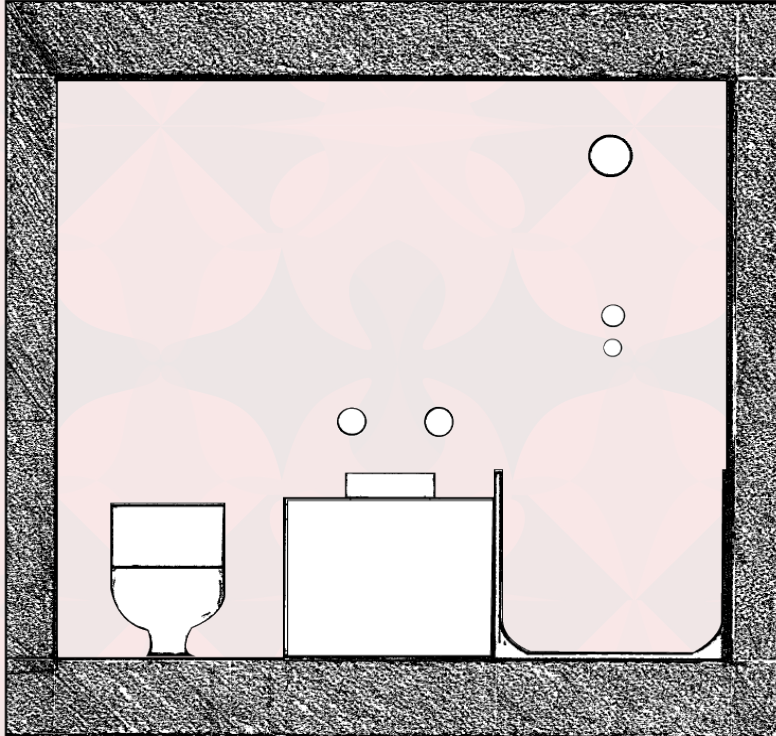

HAND DRAWING BATHROOM FLOOR PLAN DRAWING
(SECTION AND ELEVATION)

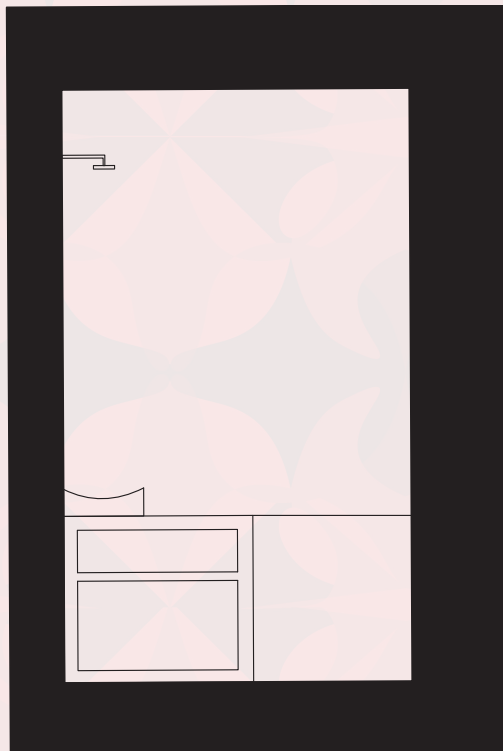
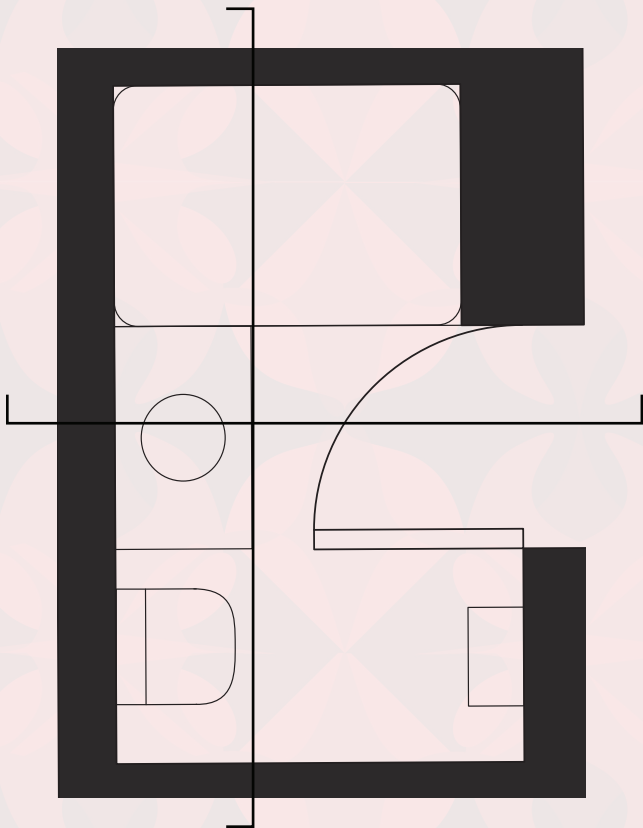

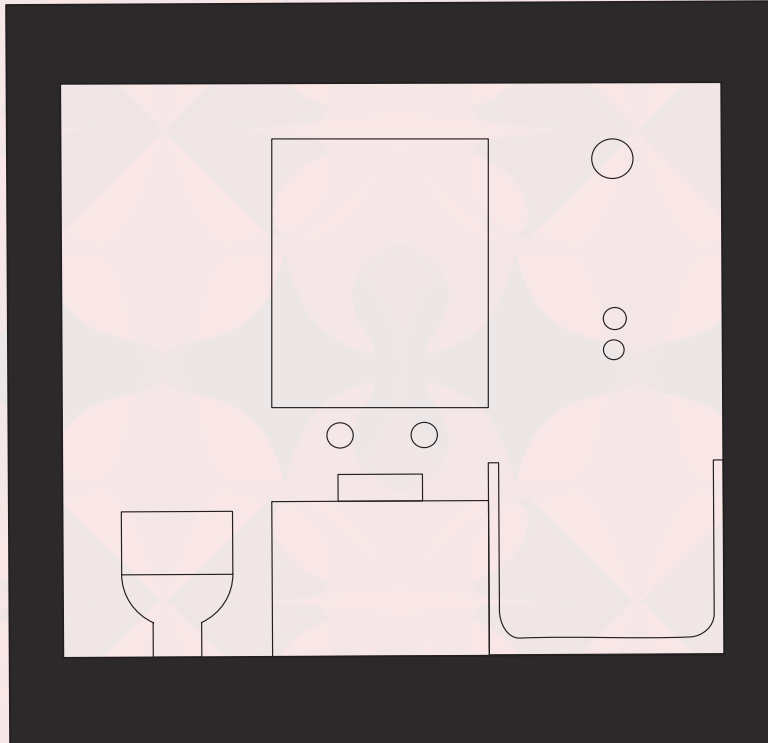

DIGITAL BATHROOM FLOOR PLAN DRAWING
(SECTION AND ELEVATION)

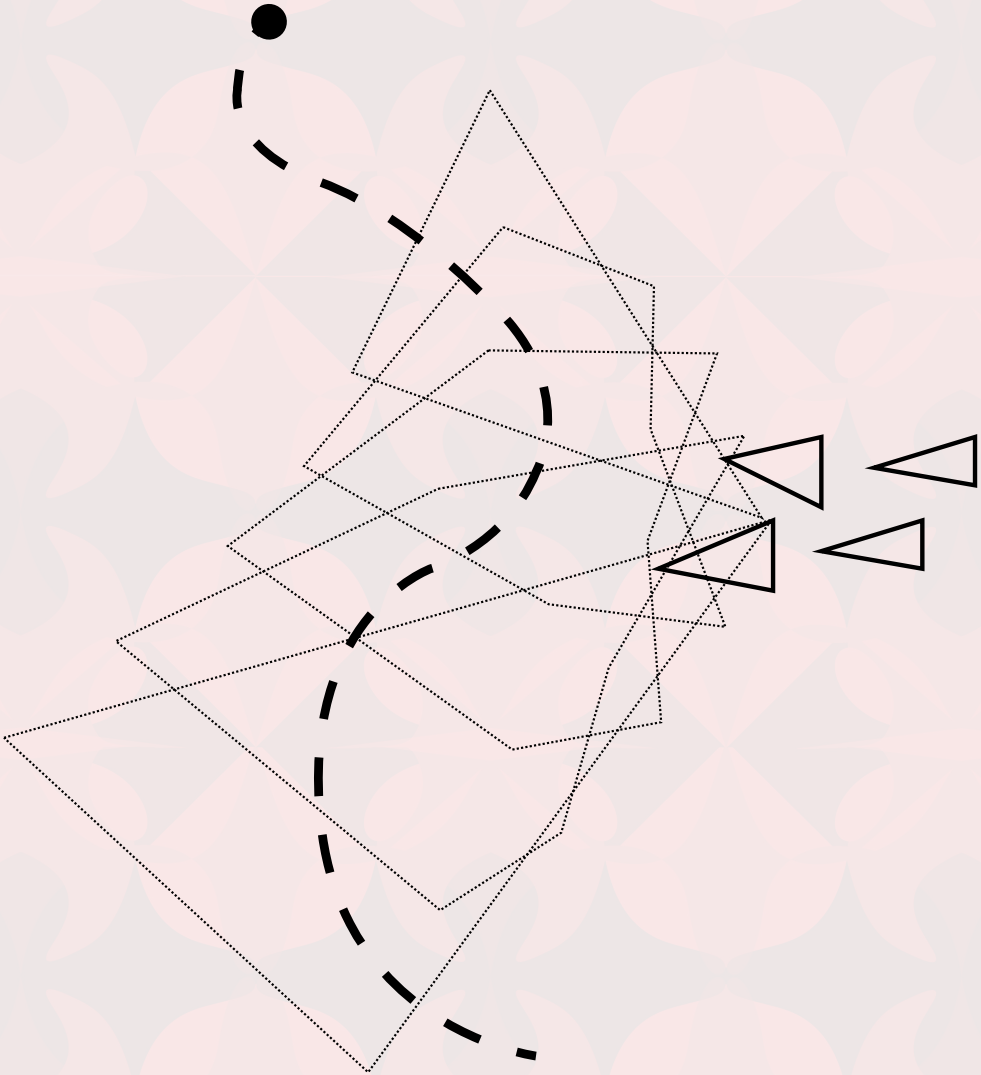

The project was focused on the motion. First we taped our selected rooms on to the floor in 1:1 scale. Secondly, we recorded motion in the taped areas. By gathering all of these recordings on illustrator, 9 images of motion were created. The graphic lines diagram these actions.



MOVEMENT ANALYSIS I



MOVEMENT ANALYSIS II

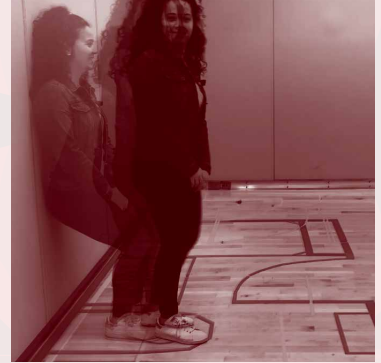

MOVEMENT ANALYSIS III



A_05

MOVEMENT ANALYSIS PLAN I



A_05

MOVEMENT ANALYSIS PLAN II

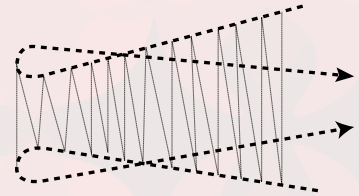

A_06

MOVEMENT ANALYSIS PLAN III



A_07

MOVEMENT ANALYSIS SECTION I

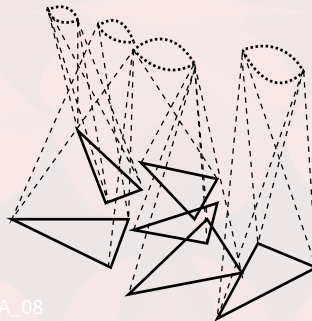

A_08

MOVEMENT ANALYSIS SECTION II

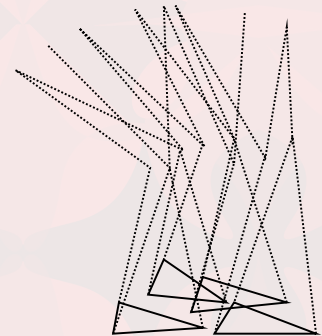

MOVEMENT ANALYSIS SECTION III



MOVEMENT ANALYSIS IV

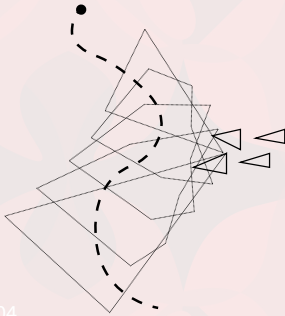

B_04

MOVEMENT ANALYSIS PLAN IV



MOVEMENT ANALYSIS V

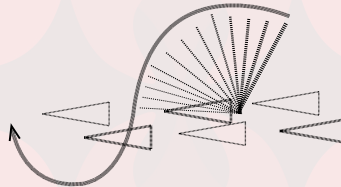

B_05

MOVEMENT ANALYSIS PLAN V



MOVEMENT ANALYSIS VI

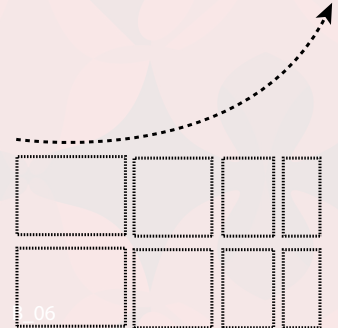

B_06

MOVEMENT ANALYSIS PLAN VI

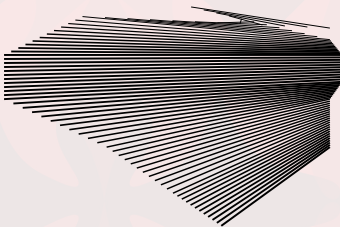

MOVEMENT ANALYSIS SECTION IV

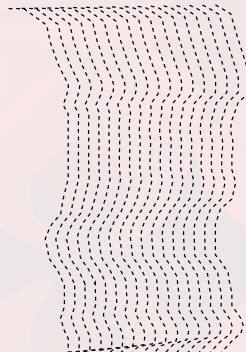

B_07

MOVEMENT ANALYSIS SECTION V



B_08

MOVEMENT ANALYSIS SECTION VI



MOVEMENT ANALYSIS VII



MOVEMENT ANALYSIS VIII



MOVEMENT ANALYSIS IX



MOVEMENT ANALYSIS PLAN VII

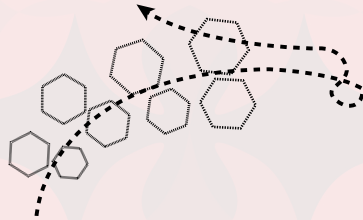

MOVEMENT ANALYSIS PLAN VIII

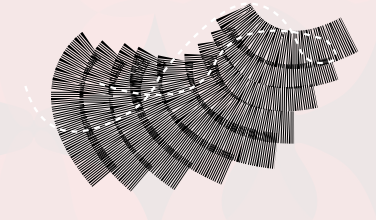

MOVEMENT ANALYSIS PLAN IX

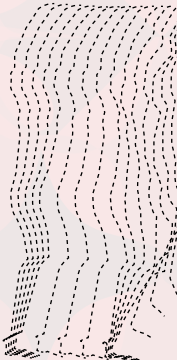

MOVEMENT ANALYSIS SECTION VII

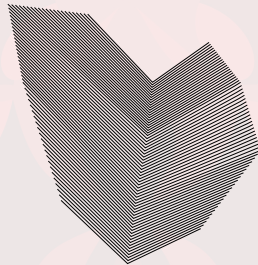

MOVEMENT ANALYSIS SECTION VIII



MOVEMENT ANALYSIS SECTION IX

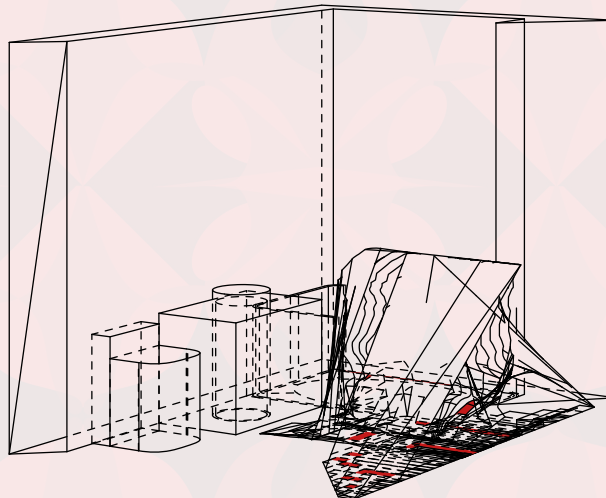

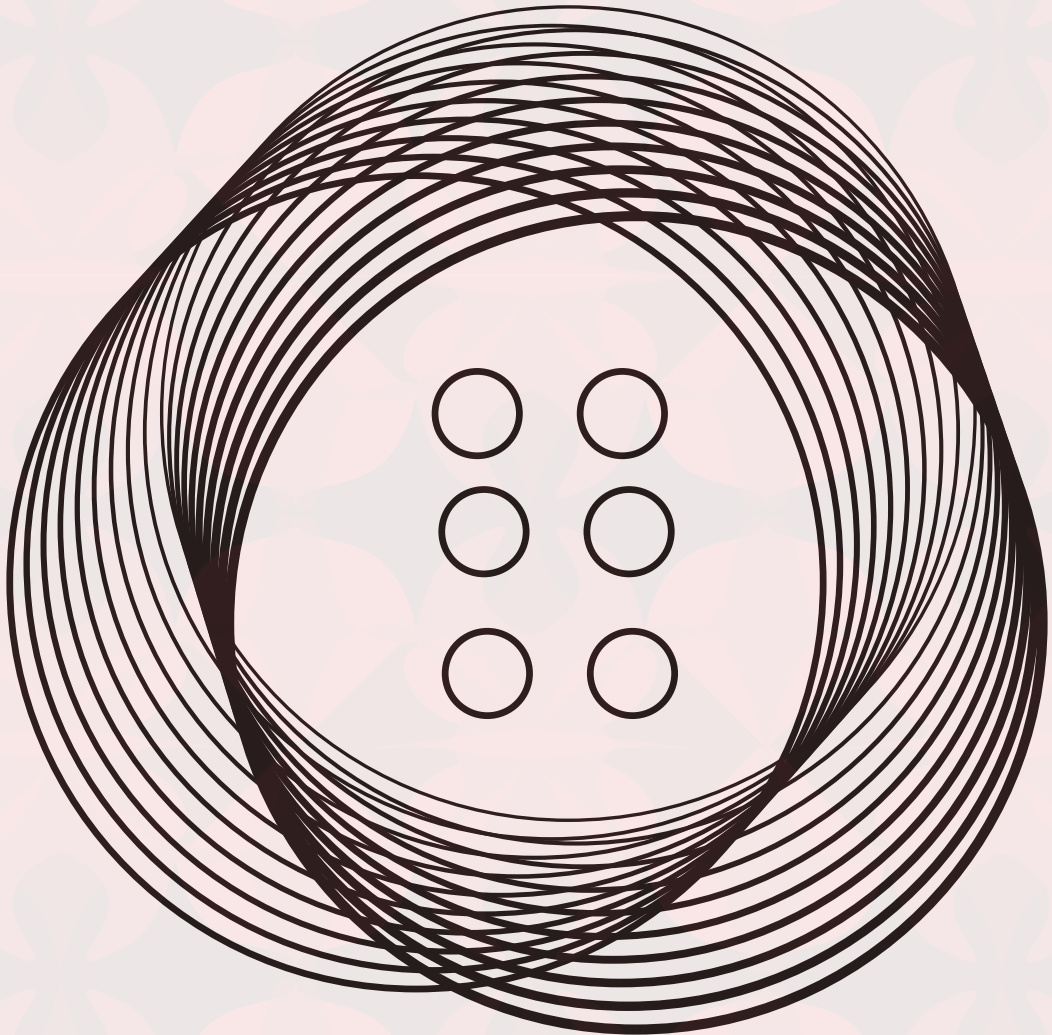

This part of the project was re creating the bathroom design for an animal we chose. I chose Gloria from the movie Madagascar so I started re creating a design for her taste. I chose a flower as my main structure and edited the petals to create a whole new dimension to the already existing flower form. The form of the petals were distoreted in a way that would create privacy, performance area and resting paths. The main design was based on her needs and character.



MOVEMENT ANALYSIS I



MOVEMENT ANALYSIS II

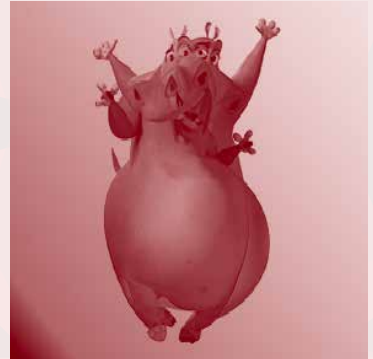

MOVEMENT ANALYSIS III

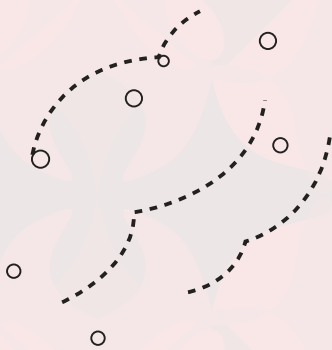

MOVEMENT ANALYSIS PLAN I



MOVEMENT ANALYSIS PLAN III

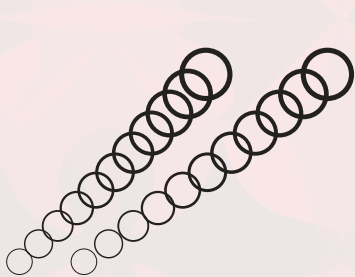

MOVEMENT ANALYSIS SECTION I

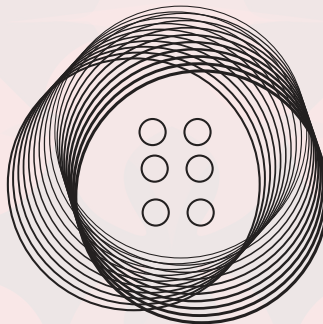

MOVEMENT ANALYSIS SECTION II



MOVEMENT ANALYSIS SECTION III

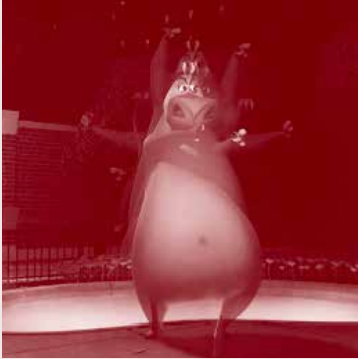

MOVEMENT ANALYSIS IV

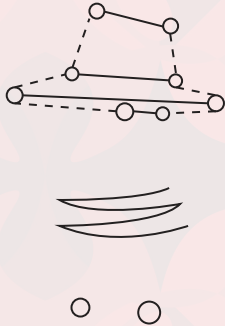

MOVEMENT ANALYSIS PLAN IV



MOVEMENT ANALYSIS SECTION IV



MOVEMENT ANALYSIS V

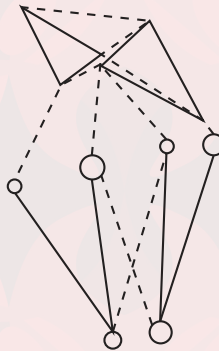

MOVEMENT ANALYSIS PLAN V



MOVEMENT ANALYSIS SECTION V

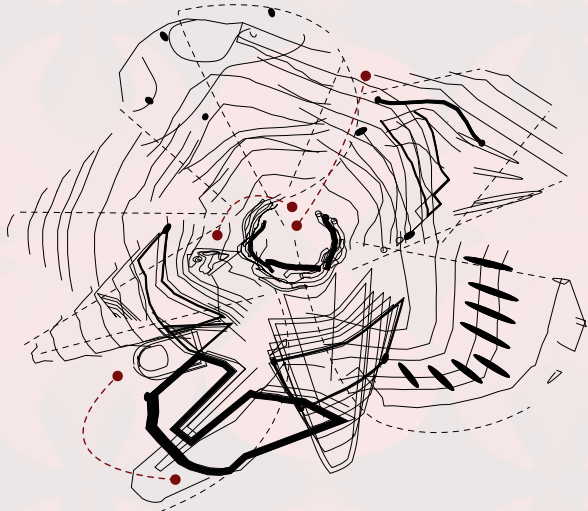
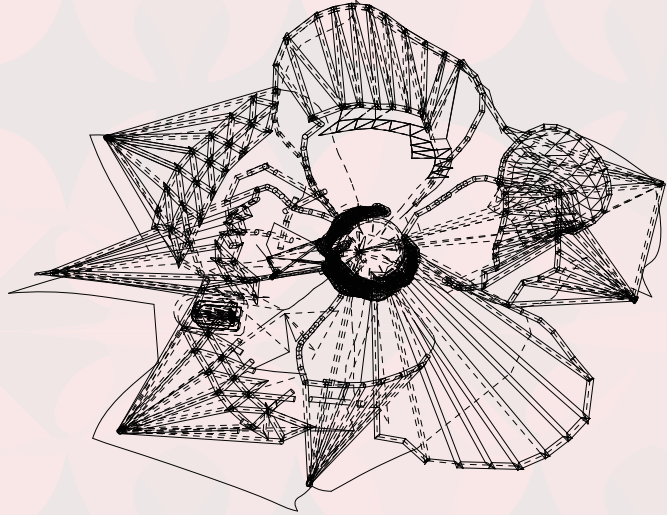
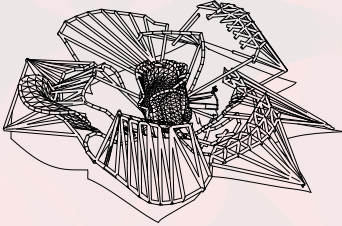

PLAN



PLAN

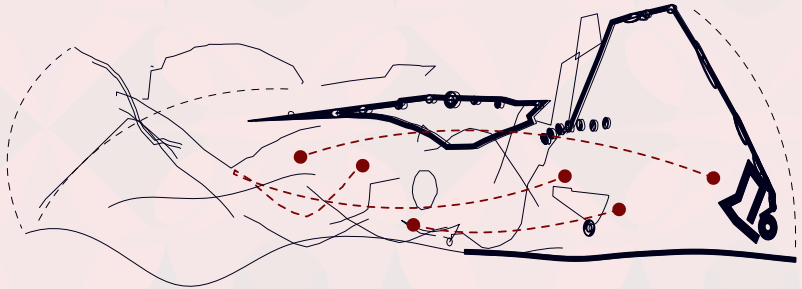
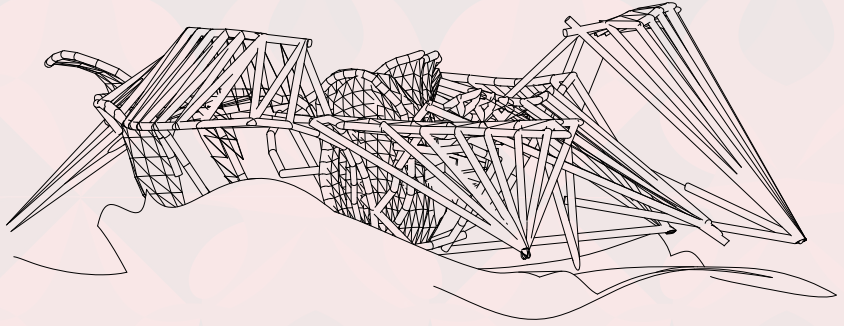

SECTION

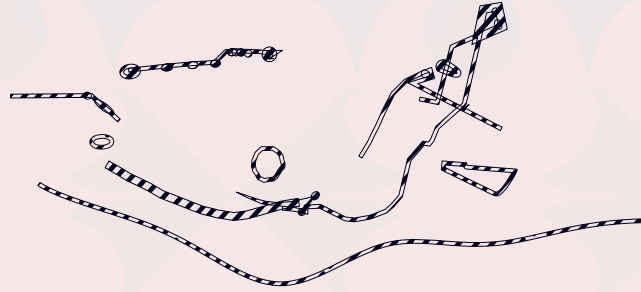
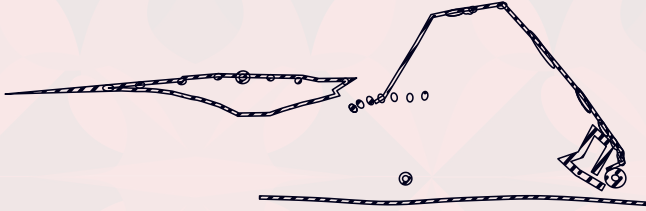



RENDER I

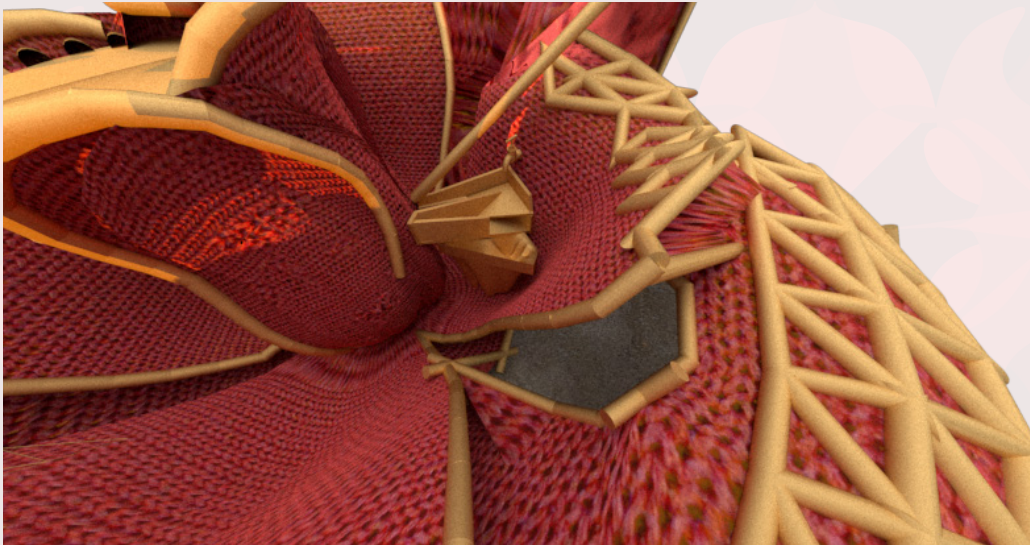

RENDER III



RENDER II

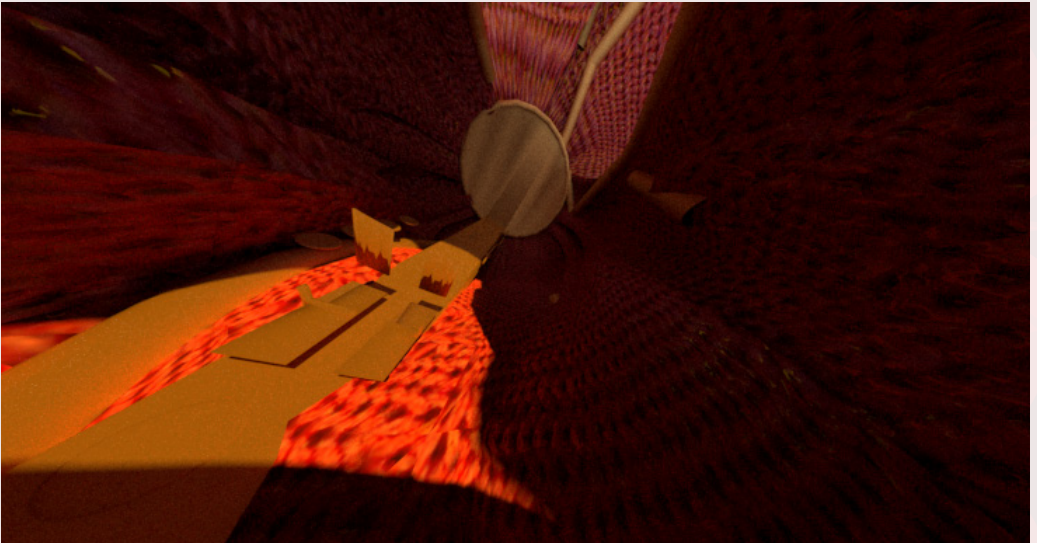

RENDER IV

